

## Interchange Element Data Sheet

Data sheet created using the Parker Par Fit Toolkit software.

<b>Creation Date:</b>	22/08/2018
<b>Datasheet No:</b>	AM000082
<b>Parker Part No:</b>	R270PL
<b>Element Style:</b>	Fuel
<b>Fluid Type:</b>	Spin On Canister

### Product Dimensions

<b>A: (mm)</b>	150.0	<b>(in)</b>	5.91
<b>B: (mm)</b>	110.0	<b>(in)</b>	4.33

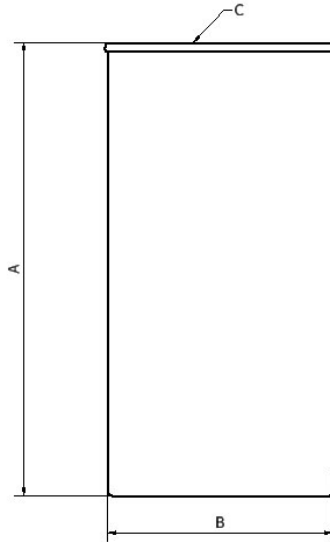

### Media Performance

<b>Micrometer Rating (&gt;98%)</b>	10 micron
<b>OE Applications:</b>	MAN

### Filtration Data

<b>Nominal Flow Rate (LPH):</b>	270.00	<b>(GPH)</b>	71.00
<b>Burst Pressure (Max):</b>	30.00		
<b>Collapse Pressure of element:</b>	2.06		